

Multipurpose

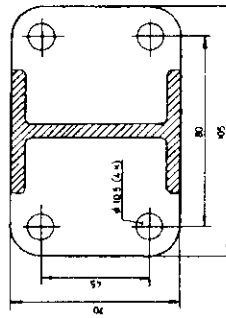
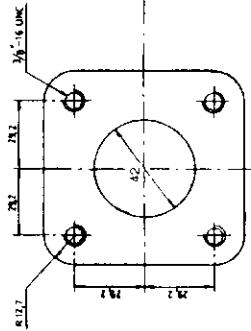
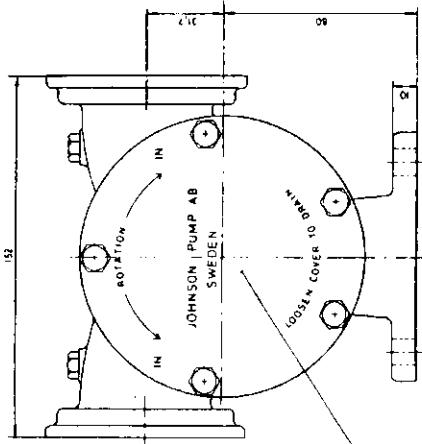
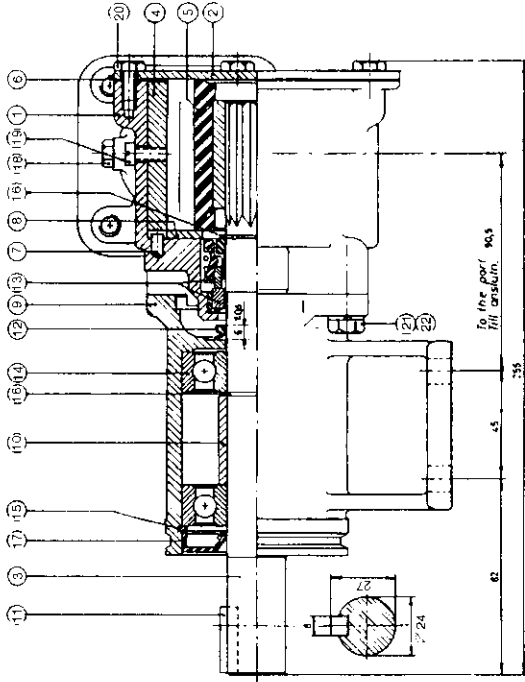

22	4	Washer	Bricka	05-02-101
21	4	Screw	Skriv	05-04-128
20	5	Screw	Skriv	05-04-46
19	1	Screw	Skriv	See table
18	2	Plug	Plugg	05-03-122
17	1	Lip seal	Lipslätning	05-29-118
16	2	Retaining ring	Låsring	05-34-108
15	1	Retaining ring	Låsring	05-34-118
14	2	Ball bearing	Kullager	05-08-504
13	1	Mech. seal	Mek. tätning	05-20-118
12	1	V-ring	V-ring	05-19-505
11	1	Key	Nil	01-42747
10	1	Spacer	Distans	01-42747
9	1	Pedestal	Lagerfot	01-13020
8	1	Wear plate	Slitoricka	01-42423
7	1	Pin	Stift	01-42426
6	1	Gasket	Packning	01-42424
5	1	Impeller	Impeller	See table
4	1	Cam	Kam	See table
3	1	Shaft	Åxel	01-35137
2	1	End cover	Lock	01-42422-1
1	1	Body	Pumphus	01-11206
Pos.	Qty.	Description	Material	Dimension

PUMP NO	PUMPTYP	PUMPTYP	PUMPTYP	IMPELLER		CAM		CAM	CAM
				NO	DESCRIPTION	NO	DESCRIPTION		
10-1300-1	F8B-3000	10-1300-1	10-1300-1	05-02-101	1/2	01-42424	05-04-128	05-04-128	05-04-128
10-1300-2	F8B-3000	10-1300-2	10-1300-2	05-02-101	1/2	01-42424	05-04-128	05-04-128	05-04-128
10-1300-3	F8B-3000	10-1300-3	10-1300-3	05-02-101	1/2	01-42424	05-04-128	05-04-128	05-04-128
10-1300-4	F8B-3000	10-1300-4	10-1300-4	05-02-101	1/2	01-42424	05-04-128	05-04-128	05-04-128

10-1300-1	10-1300-2	10-1300-3	10-1300-4
10-1300-1	10-1300-2	10-1300-3	10-1300-4
10-1300-1	10-1300-2	10-1300-3	10-1300-4
10-1300-1	10-1300-2	10-1300-3	10-1300-4

Johnson Impellerpump
Type F8B-3000. 10-13024