

CONNECTION INSTRUCTIONS

PLACE THE HOTPOT IN POSITION AND SECURE DOWN THROUGH ITS FOUR FIXING FEET.

Note 1: When installed horizontally the hot water take off (1a) must be at 12 O'clock (the highest point)

Note 2: When installing vertically, the fittings must be at the top. On larger size tanks the immersion may not heat the entire tank as quickly as expected.

Fig 1
Connect your plumbing to the mixer valve (1a) for your hot water supply.

The calorifier is fitted with a temperature mixing valve. (1) To set the valve turn anti clockwise to the maximum, this will give a maximum water temperature of 65°C. When the knob is fully closed i.e clockwise it is set to 45°C.

Connect your cold feed to the lowest fitting (2) supply from pressure pump cold water to the calorifier.

Engine connections. Connect the calorifier to the engine cooling circuit. Heater hose (206416) can be used for this application. (Single coil shown. Twin coil Hotpots available)

Pipe the outlet of the pressure release valve (4a) to the bilges (16mm heater hose is acceptable) Ensure this is in a safe position as any discharge from here may be very hot.

Secure all flexible plumbing connections with quality worm drive hose clips.

Fig 2
The immersion is pre-set to 80°C, this can be altered with a screwdriver on the stat which is under the red cover (5) The 240 volt supply to the immersion must not be switched on unless the boiler is filled with water. Do not remove this cover whilst connected to 220-240 volt hook up or generator that is switched on.

Fig 3
An expansion tank should be fitted on the hot supply after the tank. This will help relieve the increased pressure caused by hot water expansion and also smooth out erratic pump operation. For further pump performance, an accumulator tank can be fitted after the pump on the cold feed line. This will help reduce rapid pump on/off recycling. Accumulators are to be set just below the cut in pressure of the pump. For Expansion tanks you can use an accumulator however they need to be set just above the maximum pressure of the pump and below the pressure of the PRV valve.

Universal Hotpot



Typical Horizontal Mounting
(see note 1)



Typical Vertical Mounting
(See note 2)

Figure 1 Universal Calorifier

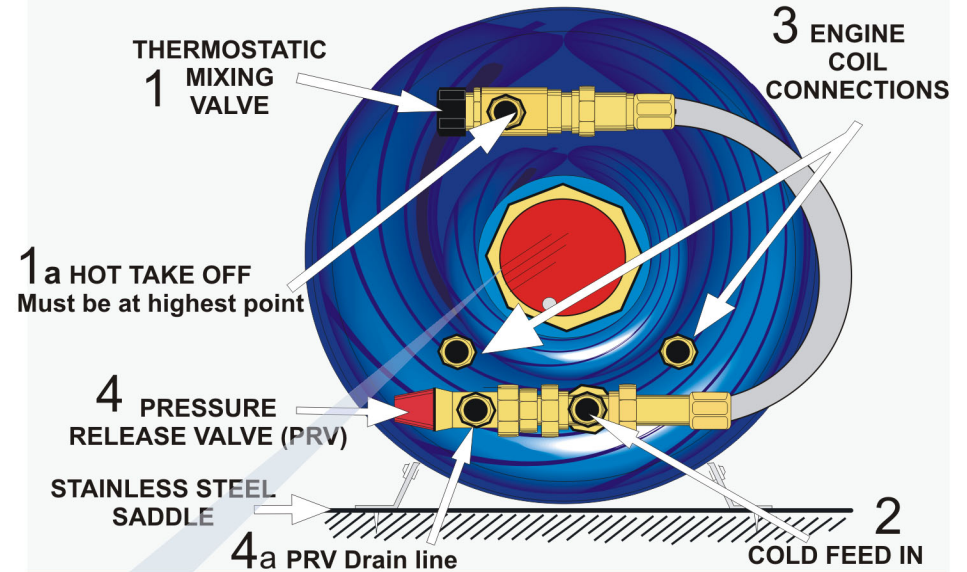
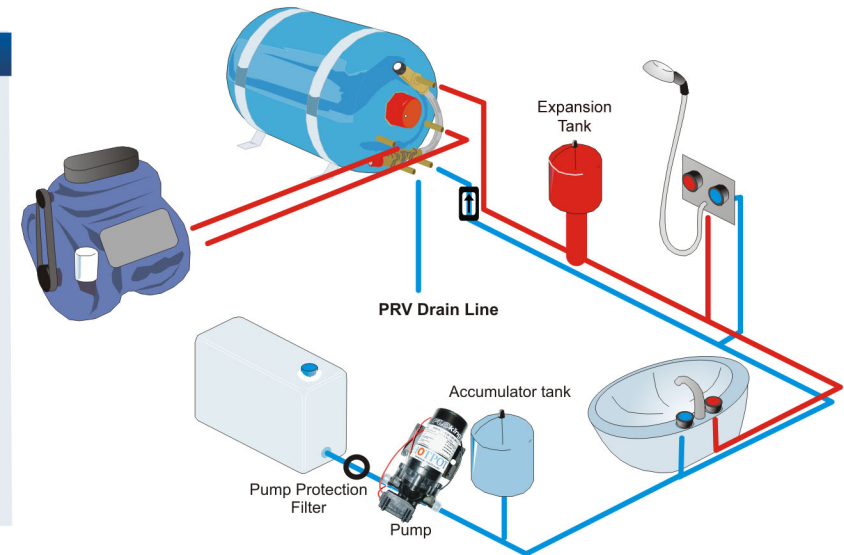
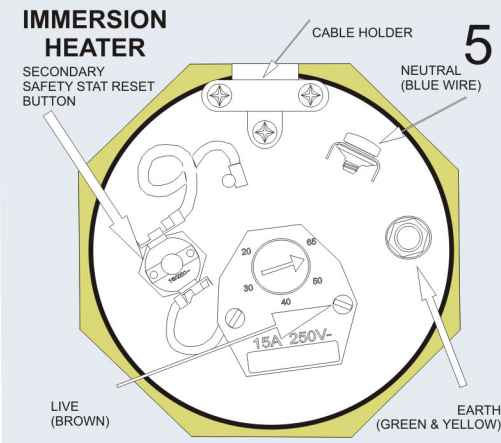

Figure 3 Typical Installation Showing Horizontal

Figure 2 Immersion



Doc No ASAP48-0020GB-0710