

ASAP 201236

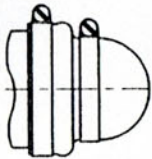

FOR ASSY AS KEEL COOLED UNIT OMIT END COVERS AND TUBESTACK FIT BODY TUBE No. 518-821B AND BLANK END COVERS DRG No.3419 MARK UP NAMEPLATE AS 3676KC

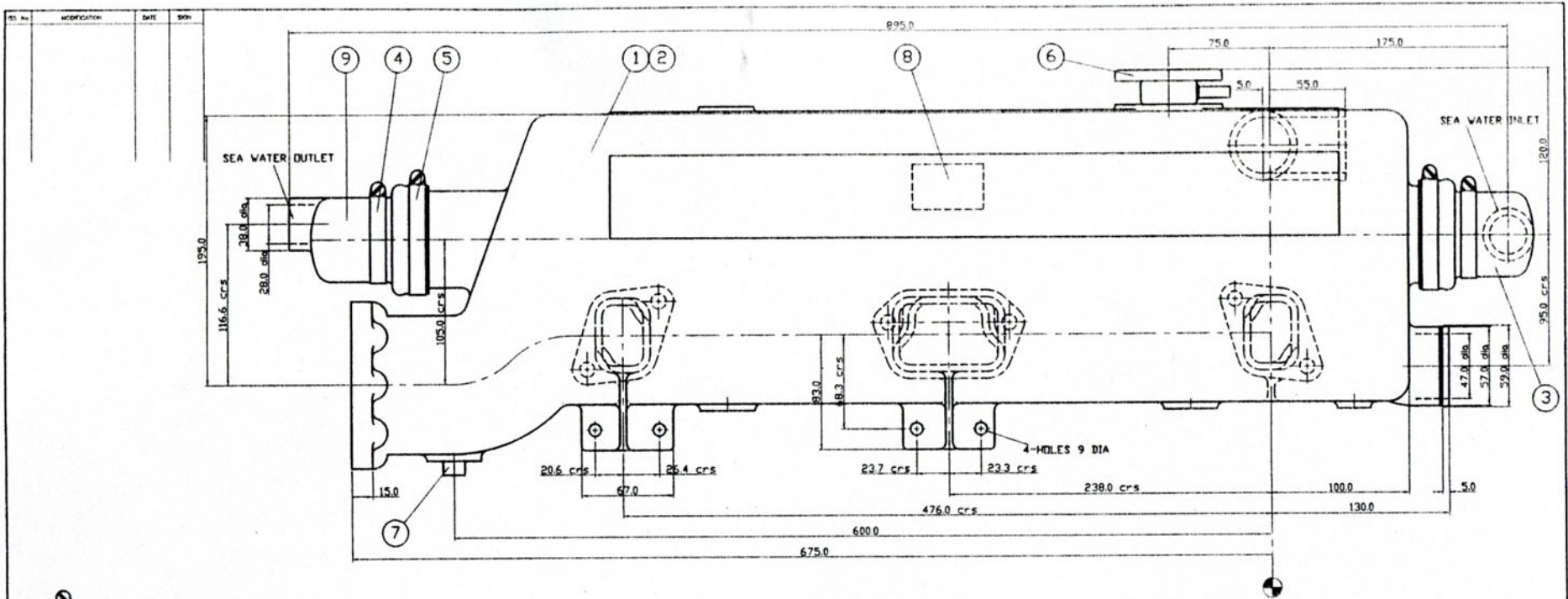
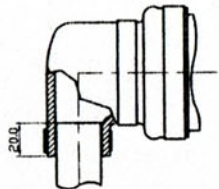

METHOD OF FIXING SEA WATER PIPE TO NEOPRENE END COVER HOSE CLIP TO BS3628 SIZE No.162 (NOT SUPPLIED)

PART NO.	DRG NO.	NO. OFF.	DESCRIPTION	ITEM	MAT.
3667	1	1	END COVER	9	NEOPRENE
3594	1	1	NAMEPLATE	8	BRASS
3593	1	1	DRAIN PLUG	7	C.I.
2747	1	1	FILLER CAP	6	
No.312	2	2	HOSE CLIP	5	S.S.
No.237	2	2	HOSE CLIP	4	S.S.
3186	1	1	END COVER	3	NEOPRENE
518-820TNI	1	1	TUBESTACK	2	CN10
PESB 3529	1	1	MANIFOLD BODY	1	LM6M

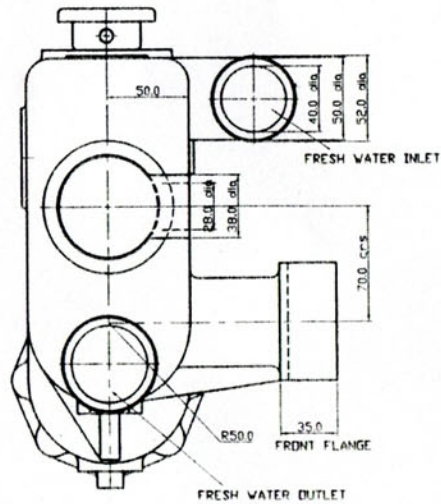
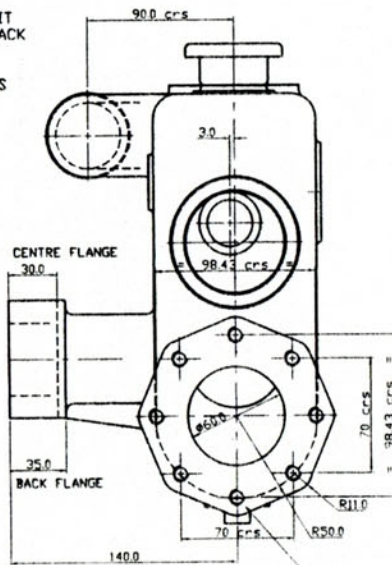

**MATERIALS**  
 BODY-ALUMINIUM LM6M  
 TUBESTACK-CUPRO NICKEL 90/10  
 END COVERS-NEOPRENE

ALL DIMENSIONS ARE IN MILLIMETRES

E.J. BOWMAN (BIRMINGHAM) LIMITED CHESTER STREET BIRMINGHAM B5 4AP		
DRAWN BY: J. J. BOWMAN DATE: 1-1-66 CHECKED BY: J. J. BOWMAN DATE: 1-1-66 DESIGNED BY: J. J. BOWMAN DATE: 1-1-66	MANIFOLD ASSY TYPE PESB0	
FULL SIZE		3676

ASAP 201236